

# Champro®



## CHAINSAW LOG HORSE

MODEL NO: CCLH1

PART NO: 3402085

ASSEMBLY & USER  
INSTRUCTIONS

---

## **INTRODUCTION**

---

Thank you for purchasing this CLARKE Loghorse.

Before attempting to use this product, it is essential that you read this manual thoroughly and carefully follow all instructions given. In doing so you will ensure the safety of yourself and that of others around you, and you can also look forward to the product giving you long and satisfactory service.

---

## **GUARANTEE**

---

This CLARKE product is guaranteed against faulty manufacture for a period of 12 months from the date of purchase. Please keep your receipt as proof of purchase.

This guarantee is invalid if the product is found to have been abused or tampered with in any way, or not used for the purpose for which it was intended.

Faulty goods should be returned to their place of purchase, no product can be returned to us without prior permission. This guarantee does not effect your statutory rights.

---

## **GENERAL SAFETY PRECAUTIONS**

---

1. Always thoroughly familiarise yourself with this product & its operation, and always read and understand the instructions and warnings in this manual before using the equipment.
2. Ensure the log horse is located on firm level ground when in use.
3. Always locate the log horse in a position where it does not pose a hazard to yourself or others in the vicinity when not in use.
4. Keep work area tidy and well lit. Cluttered or dark areas invite accidents.
5. Do not overreach. Keep proper footing and balance at all times. This enables better control of the logs and saw in unexpected situations.
6. Keep children and bystanders away while operating a chain saw. Distractions can cause you to lose control.
7. Use appropriate protective clothing as directed in the operating instructions for the chainsaw, including safety gloves and eye protection.d.

# CONTENTS

The CCLH1 Loghorse comprises the following components:

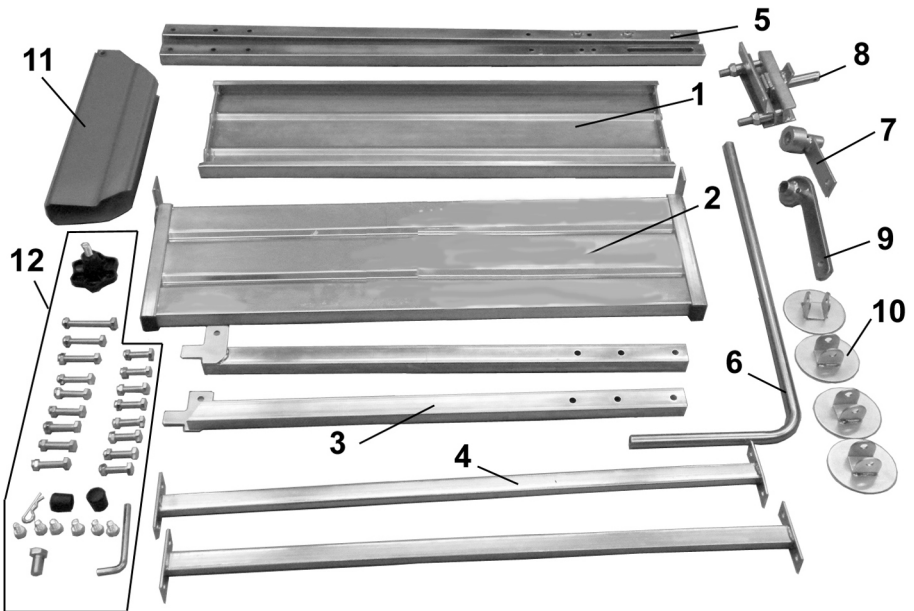

| Item | Description                 | Item | Description                    |
|------|-----------------------------|------|--------------------------------|
| 1    | Fixed Support Panel         | 7    | Measuring Rod Mounting Bracket |
| 2    | Hinged Support Panel        | 8    | Chainsaw Clamp                 |
| 3    | Short Leg                   | 9    | Clamp Mounting Bracket         |
| 4    | Cross Member                | 10   | Foot                           |
| 5    | Long Leg                    | 11   | Saw Guard                      |
| 6    | Measuring Rod (length stop) | 12   | Fixings Pack                   |

## THE FIXINGS PACK

The fixings pack (12) includes the following:

|                                 |                      |
|---------------------------------|----------------------|
| 1 x Hand-knob                   | 2 x Plastic End Caps |
| 1 x Large Securing Bolt         | 8 x 35mm Bolts/Nuts  |
| 1 x R-clip                      | 6 x 40mm Bolts/Nuts  |
| 6 x Socket (Allen) Headed Bolts | 2 x 50mm Bolts/Nuts  |
| 1 x Allen Key                   | 1 x 65mm Bolt/Nut    |

When unpacking, check for damage or omissions etc. Any found should be reported to your CLARKE dealer where the product was originally purchased. Do not discard the packaging until the product is assembled.

## ASSEMBLY

1. Join the two short legs (3) together with one of the cross member (4) using the 35 mm bolts & nuts as in Fig 1.
2. Ensure that the locking flanges are on the outside of the assembly as in Fig 2.
  - Repeat with the two long legs (5) and the second cross-member.
3. Bolt the feet (10) to each of the legs using 4 x 40 mm bolts & nuts as shown in Fig 1.
4. Join the tops of the two leg assemblies together using 2 x 40 mm bolts and nuts.
  - The legs should hinge freely when assembled.

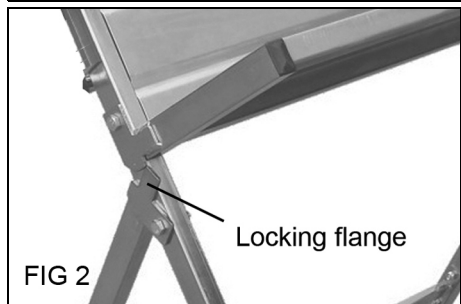
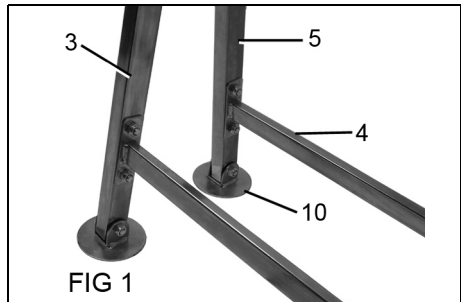

5. Secure the fixed support panel (1) in place between the long legs using 6 Allen headed bolts and the socket wrench supplied as shown in Fig 3.
6. Attach the hinged support panel (2) to the long legs using the 2 x 50 mm bolts & nuts.

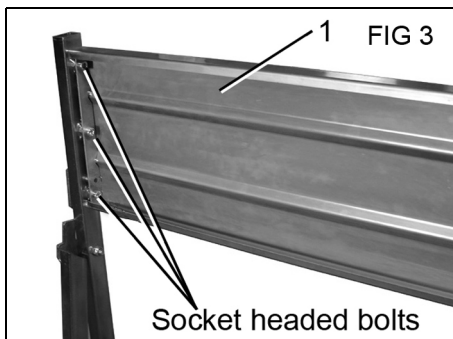

7. Insert the pivot clamp mounting bracket (7) into the top of the long leg as shown in Fig 4.
  - Take note of the way it is facing in the diagram.
8. Using the large securing bolt, secure the measuring rod mounting bracket (9) to the bolt hole in the pivot clamp mounting bracket as shown in Fig 4.

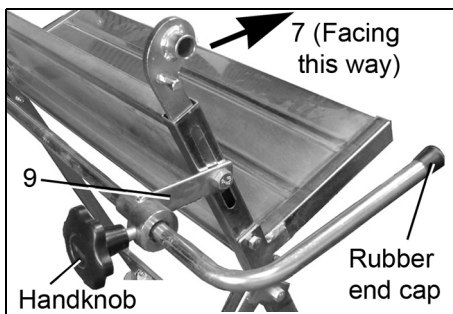

9. Slide the measuring rod (6), into the hole in the measuring rod mounting bracket (9) and secure with the handknob as shown in Fig 4. Press the rubber end caps into place at the ends of the rod.

**NOTE:** The measuring rod can be adjusted horizontally to allow each log to be cut equally to the desired length.

10. Take your chainsaw and secure it between the two solid blocks on the inside faces of the chainsaw clamp as shown in Fig 5.
  - Make sure that the chainsaw is at 90 degrees to the assembly before tightening the clamp bolts to grip the chainsaw in place. Take care that the clamp blocks grip the chain bar centrally and are clear of the moving chain.

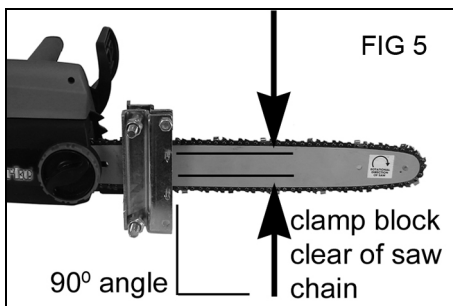

11. Attach the saw guard (11) to the chainsaw clamp using the nut & 65mm bolt as shown in Fig 6. Do not overtighten.

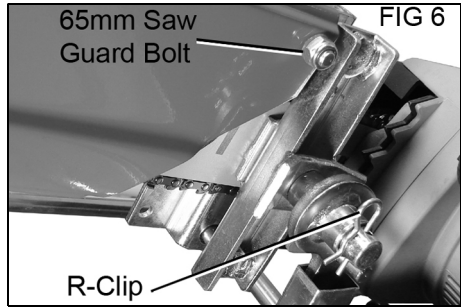

12. Once tightened, take the saw and the clamp assembly together and insert the pivot rod of the clamp into the hole in the clamp support. Secure in place with the R-clip as shown in Fig 6.

13. Test the arc of travel to make sure that the chainsaw does not touch any part of the log horse.

14. Adjust the height of the clamp and measuring rod to suit the size of the logs being cut as shown in Fig 7.

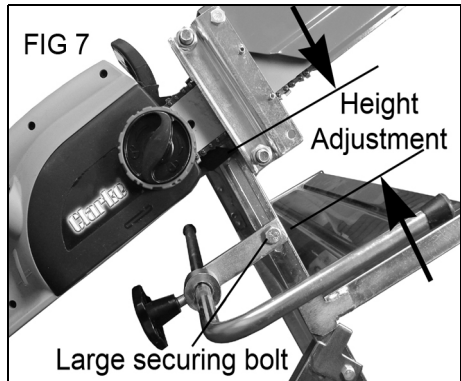

**NOTE:** The chainsaw clamp support can be adjusted vertically to accommodate different sized chain saws - the larger and longer the saw, the higher the pivot clamp should be positioned.

15. Use the large securing bolt to adjust the saw height, so that the tip of your chainsaw ends just past the table and is able to cut completely through the log.

The Log Horse is now ready for use.

---

## SAFE OPERATION

---

The log horse should only be used on firm, level surfaces. It should not be used for logs larger than those stated in the specification.

Chainsaws with a chain bar longer than 450 mm should not be used, since the chain would protrude beyond the chain guard.

When using a chainsaw with the log horse it is essential that you follow all safety guidelines in the instruction manual supplied with your chainsaw. You should also follow any other appropriate health and safety regulations.

1. Ensure the nuts and bolts on the pivot clamp and guard are kept tight before starting work.

2. Place the log on the log horse and butt the end of the log up against the measuring rod.
3. Hold the log down firmly with your left hand, keeping your hand well away from the cutting chain at all times as shown in Fig 8.

- Allow the chainsaw to do the work, do not force the chainsaw through the log.

4. Detach the pivot clamp and guard by removing the R-clip when using the log horse separately from the chainsaw.
5. All moving / adjustable parts should be kept sufficiently lubricated to resist corrosion. Store in a dry place not exposed to the weather.
6. When operating an electric chainsaw always use a residual current device (RCD) to ensure it will cut out in the event of difficulties arising.



## SPECIFICATIONS

| Feature                        | Specification      |
|--------------------------------|--------------------|
| Maximum Chain Bar length       | 450mm              |
| Maximum Log Length             | 1800mm             |
| Maximum Log Diameter           | 200mm              |
| Maximum Log Weight             | 120kg              |
| Product Weight                 | 11.1kg             |
| Product Dimensions (W x D x H) | 1310 x 715 x 785mm |
| Product Footprint (L x W)      | 715 x 815mm        |

Please note that the details and specifications contained herein, are correct at the time of going to print. However, CLARKE International reserve the right to change specifications at any time without prior notice.

## ENVIRONMENTAL PROTECTION

Recycle unwanted materials instead of disposing of them as waste. All unwanted accessories & packaging should be sorted and taken to a recycling centre for disposal in a manner which is compatible with the environment.

# A SELECTION FROM THE VAST RANGE OF

# Clarke®

## QUALITY PRODUCTS

### AIR COMPRESSORS

From DIY to industrial, Plus air tools, spray guns and accessories.

### GENERATORS

Prime duty or emergency standby for business, home and leisure.

### POWER WASHERS

Hot and cold, electric and engine driven - we have what you need

### WELDERS

Mig, Arc, Tig and Spot. From DIY to auto/Industrial.

### METALWORKING

Drills, grinders and saws for DIY and professional use.

### WOODWORKING

Saws, sanders, lathes, mortisers and dust extraction.

### HYDRAULICS

Cranes, body repair kits, transmission jacks for all types of workshop use.

### WATER PUMPS

Submersible, electric and engine driven for DIY, agriculture and industry.

### POWERTOOLS

Angle grinders, cordless drill sets, saws and sanders.

### STARTERS/CHARGERS

All sizes for car and commercial use.



**PARTS & SERVICE: 0208 988 7400**

**E-mail: [Parts@clarkeinternational.com](mailto:Parts@clarkeinternational.com) or [Service@clarkeinternational.com](mailto:Service@clarkeinternational.com)**

**SALES: UK 01992 565333 or Export 00 44 (0)1992 565335**

**Clarke®** INTERNATIONAL Hemnall Street, Epping, Essex CM16 4LG  
[www.clarkeinternational.com](http://www.clarkeinternational.com)